

6 - ENGLISH

SM600-1 & SM600-2 PARTS LISTING

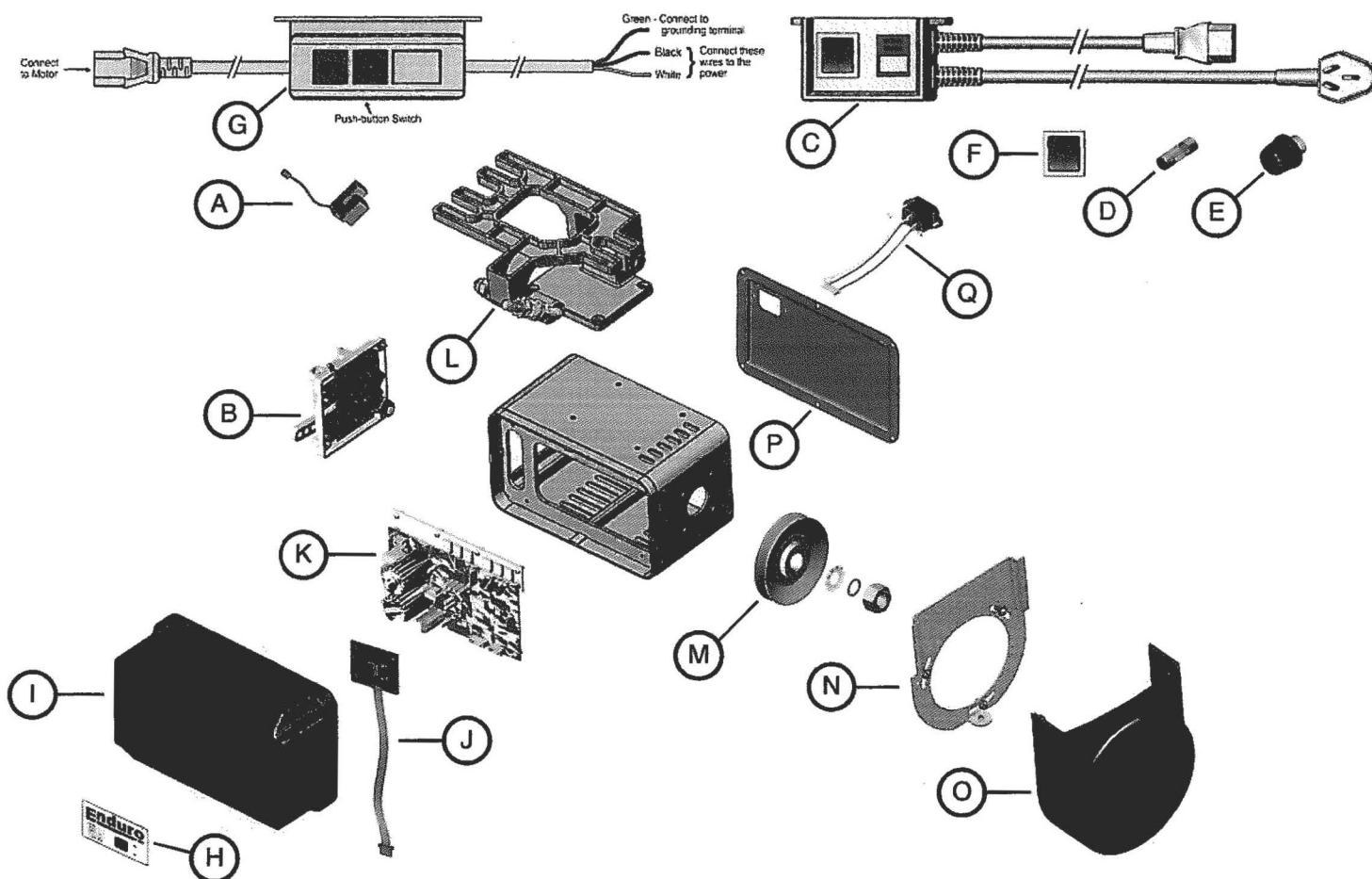

No. Fig. Description

SM68	A	Sensor only with screws (single channel for non-positioner motor)
SM603	B	Treadle Sensor Plate Assembly complete with 4 screws (single channel for non-positioner motor) (431C)
SM618	C	Complete wire harness for 110 volt models, fused (877C)
SM619	D	Fuse only for 110 volt wire harness
SM620	E	Fuse cap for 110 volt wire harness
SM621	F	On/Off toggle replacement switch only
SM78	G	Complete horizontal wire harness for 220 volt models (431C)
SM622	H	SM600-1 label
SM623	H	SM600-2 label
SM625	I	SM600 Pro control box cover with 4 screws (431C Matte)
SM627	J	2 Digit LED display with screws
SM628	K	SM600-1 Circuit board with 6 screws
SM629	K	SM600-2 Circuit board with 6 screws
SM631	L	Motor mounting bracket complete with 4 screws (431C)
SM50	M	50mm pulley with mounting hardware
SM60	M	60mm pulley with mounting hardware
SM75	M	75mm pulley with mounting hardware
SM80	M	80mm pulley with mounting hardware
SM90	M	90mm pulley with mounting hardware
SM100	M	100mm pulley with mounting hardware
SM79	N	Pulley cover bracket with screws and washers
SM86	O	Pulley cover with screw and washer (431C Matte)
SM632	P	Rear motor cover panel SM600-1 and SM600-2 with 6 screws (431C)
SM81	R	Power inlet receptacle with wires, terminals and screws complete